

FORDE



4/21 Production Street Noosaville QLD

- Configured as 3 separated offices + kitchenette + mezzanine
- Versatile space with high bay roller door 150m sq approx
- Quality modern tilt slab construction
- Ample centre car parking
- Close to banks and other business facilities

For more information contact Donna Ingram 0413 547 914 or Connor Weldon 0402 159 213 today!

Building Size : 150 sqm

View : <https://www.fordeproperty.com.au/sale/qld/sunshine-coast/noosaville/commercial/industrial/6051734>



Donna Ingram
07 5447 5554



Tom Forde
07 5447 5554

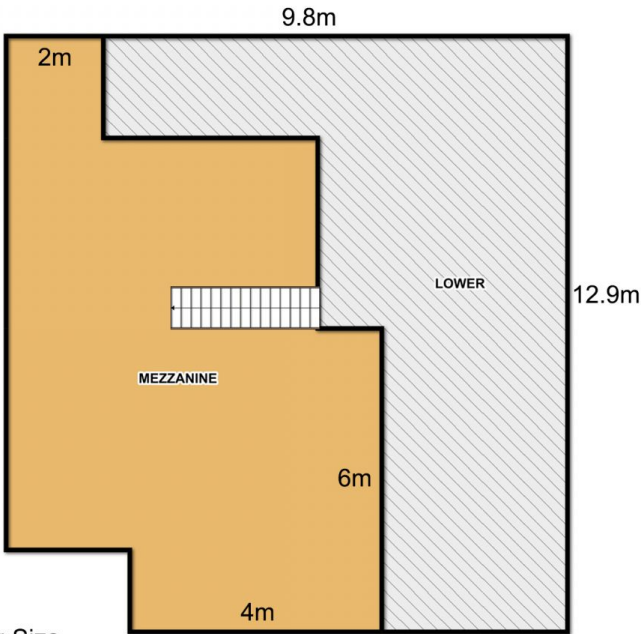
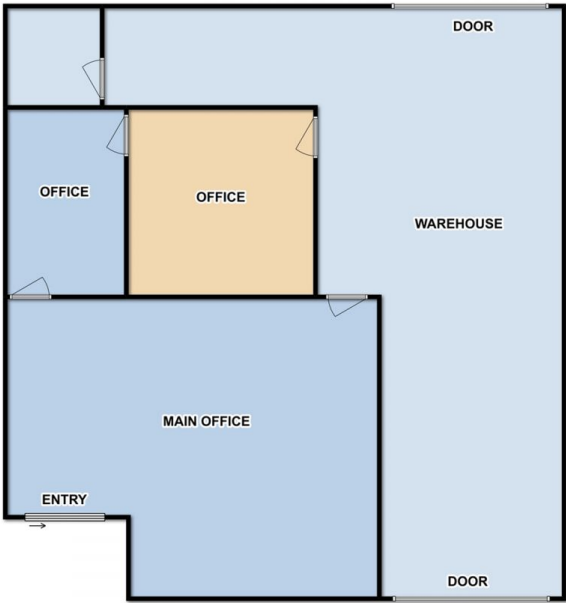

Building Size
150m²
Warehouse
150m²

This floor plan is conceptual only. It is provided for illustrative purposes only and should not be relied upon. We make no guarantee as to the accuracy of this plan. All interested parties should make and rely on their own enquiries in determining the accuracy of the information contained in this floor plan.
#NOT TO SCALE

Unit 4/21 Production Street, Noosaville