

FORDE



3/20-22 Venture Drive Noosaville QLD

Forde Property is pleased to present 3/20 Venture Drive, Noosaville . 3/20 Venture Drive has now become available for sale. The subject property is located in the Noosaville industrial precinct, the perfect location for a new business start up or to relocate your existing business.

- Modern, trendy warehouse of 128m² plus mezzanine of 44m² approx
- Quality tilt slab construction with high bay roller door access
- Amenities include bathroom facilities & kitchenette
- High speed NBN internet connection
- Ample car parking

Building Size : 172 sqm
View : <https://www.fordeproperty.com.au/sale/quick/sunshine-coast/noosaville/commercial/industrial/6051761>



Tom Forde
07 5447 5554

PROPOSED 12 FACTORY UNITS
LOTS 16 / 17 VENTURE DRIVE, NOOSAVILLE.

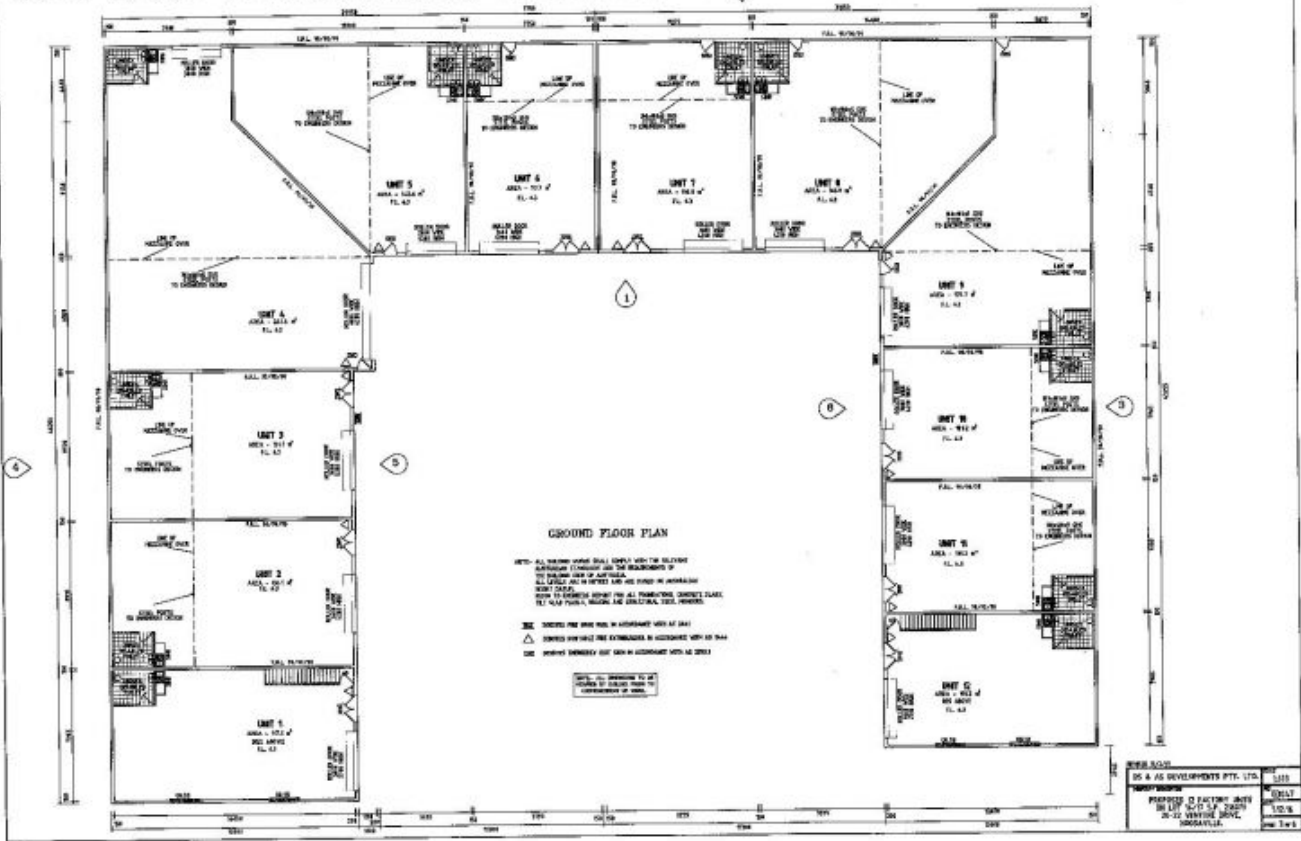

PROPOSED 12 FACTORY UNITS
LOTS 16 / 17 VENTURE DRIVE, NOOSAVILLE.

