

FORDE



4/6 Swanbourne Way Noosaville QLD

Forde Property is delighted to offer this boutique, open plan office located in the Noosaville neighbourhood centre.

- Shop 4 area: 200m² approx.
- Revamped space suitable for retail, office, gym, yoga
- Neighbouring tenancies include; Bakery, Thai restaurant, Bottle shop, Hairdresser

For more information, please contact Donna Ingram on 0413 547 914 or Kelly Legg on 0400 398 633.

Building Size : 200 sqm
View : <https://www.fordeproperty.com.au/sale/qld/sunshine-coast/noosaville/commercial/retail/6139668>



Donna Ingram
07 5447 5554

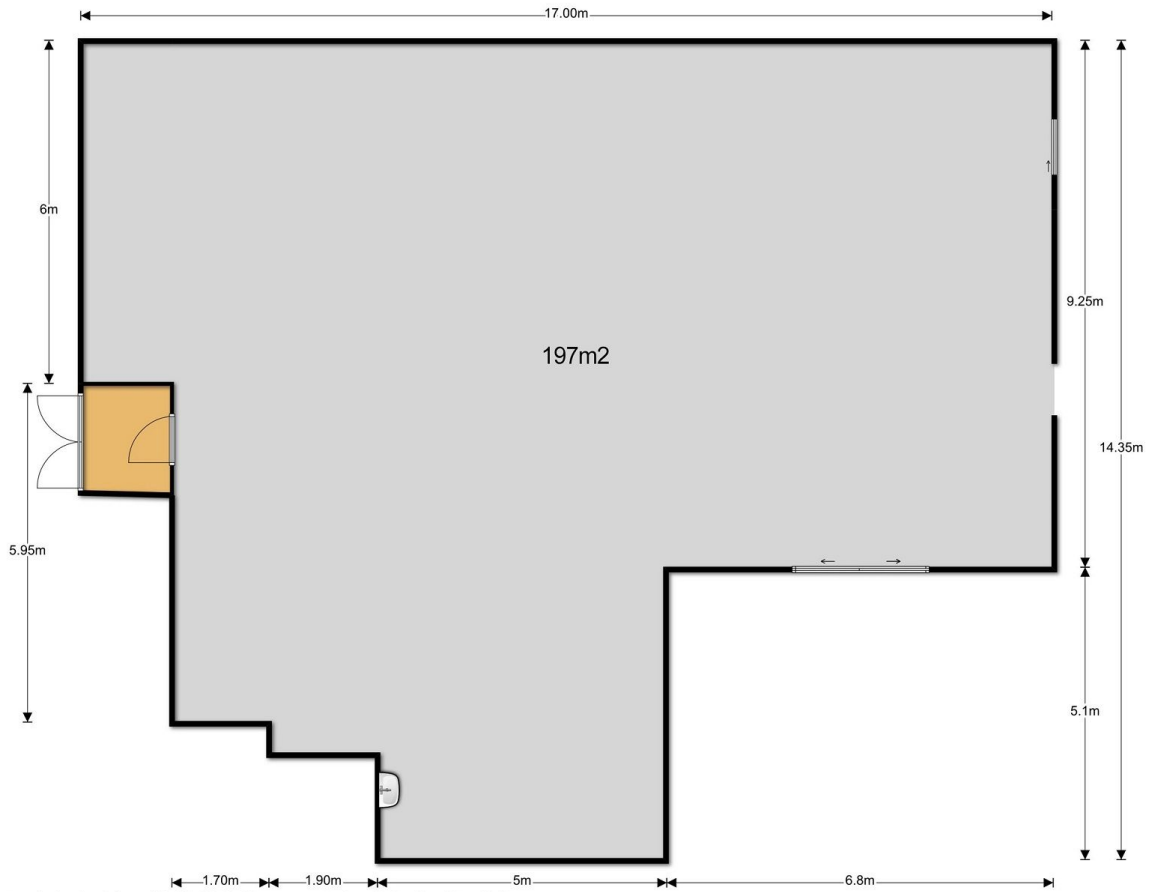

This floor plan is conceptual only. It is provided for illustrative purposes only and should not be relied upon. We make no guarantee as to the accuracy of this plan. All interested parties should make and rely on their own enquiries in determining the accuracy of the information contained in this floor plan.

#NOT TO SCALE