

# FORDE



## 5/6 Swanbourne Way Noosaville QLD

Exciting opportunity for a restaurant to operate in the popular Noosaville neighbourhood centre within the surrounding estates of Bushlands, Beckman's Green and Doonella. This versatile 103m<sup>2</sup> is also suitable for office space. Conveniently located close to busy Noosa Eumundi Road. This premises is available for lease NOW.

- Premises 103m<sup>2</sup> (approx.)
- Large onsite car park
- Neighbouring tenancies include; Noosaville Bakery, Chada Thai Restaurant, Liquorland Bottle Shop, Noosaville Hair and Beauty, Noosa Mind and Body
- Adjacent to Goodstart child care

For more information, please contact Donna Ingram

**Price** : \$3,278 P/M + Outs + GST  
**Building Size** : 103 sqm  
**View** : <https://www.fordeproperty.com.au/lease/qld/sunshine-coast/noosaville/commercial/retail/7897729>



**Donna Ingram**  
07 5447 5554

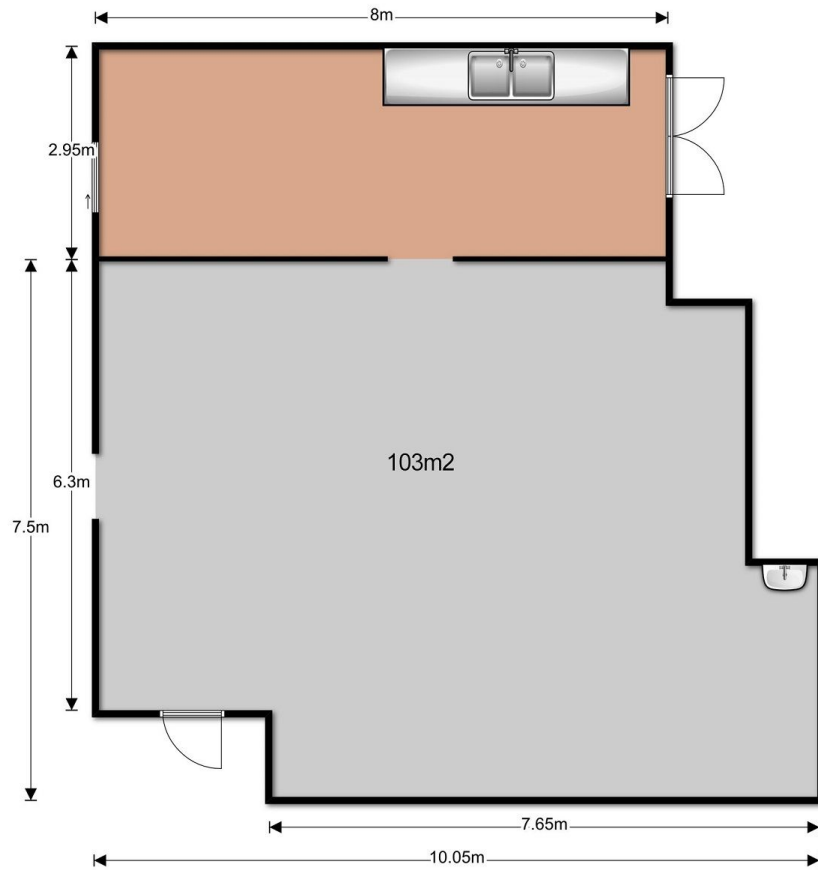

This floor plan is conceptual only. It is provided for illustrative purposes only and should not be relied upon. We make no guarantee as to the accuracy of this plan. All interested parties should make and rely on their own enquiries in determining the accuracy of the information contained in this floor plan.

#NOT TO SCALE